

First Floor  
[1639.23 Sq ft]

TOTAL Sketch by a la mode

**Area Calculations Summary**

Living Area		Calculation Details
First Floor	1639.23 Sq ft	$30.3 \times 54.1 = 1639.23$
<b>Total Living Area (Rounded):</b>	<b>1639 Sq ft</b>	

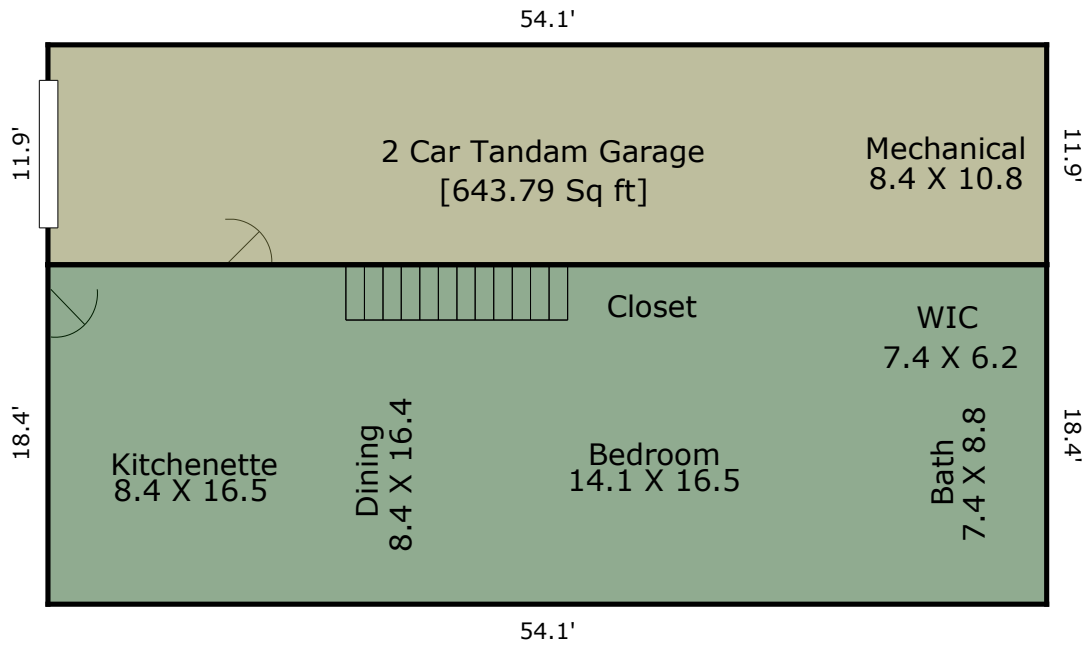

Basement  
[995.44 Sq ft]

TOTAL Sketch by a la mode

**Area Calculations Summary**

**Non-living Area**

2 Car Attached	643.79 Sq ft	$11.9 \times 54.1 = 643.79$
Basement	995.44 Sq ft	$18.4 \times 54.1 = 995.44$