

TOTAL Sketch by a la mode

**Area Calculations Summary**

Living Area		Calculation Details
First Floor	1184.93 Sq ft	$5.6 \times 1.3 = 7.28$ $23.9 \times 17.2 = 411.08$ $23.3 \times 32.9 = 766.57$
<b>Total Living Area (Rounded):</b>		<b>1185 Sq ft</b>
Non-living Area		
1 Car Attached	305.14 Sq ft	$20.9 \times 14.6 = 305.14$
Front Porch	65.7 Sq ft	$7.3 \times 9 = 65.7$
Storage	50.63 Sq ft	$8.3 \times 6.1 = 50.63$

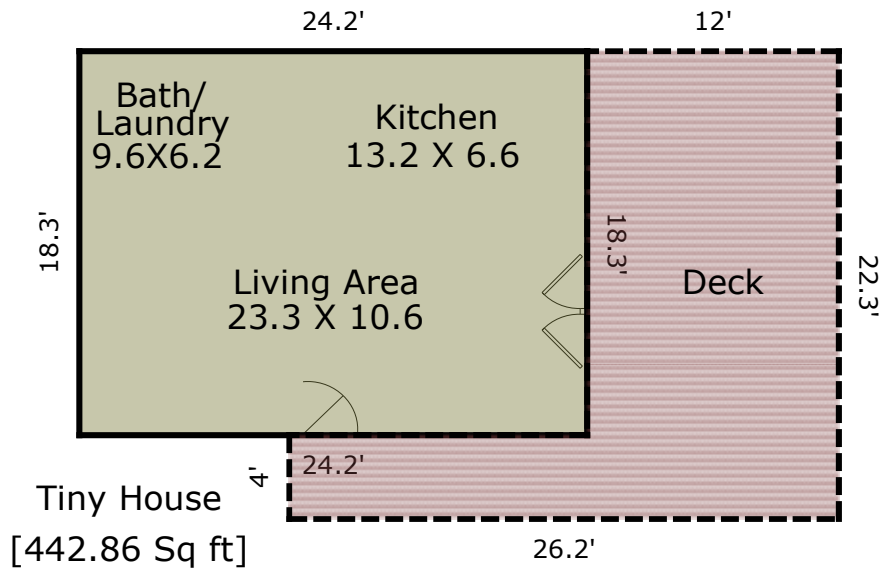

TOTAL Sketch by a la mode

**Area Calculations Summary**

**Non-living Area**

Wood Deck	324.4 Sq ft	$12 \times 18.3 = 219.6$ $26.2 \times 4 = 104.8$
Tiny House	442.86 Sq ft	$24.2 \times 18.3 = 442.86$