

TOTAL Sketch by a la mode

Area Calculations Summary

Living Area		Calculation Details	
First Floor	2383.61 Sq ft	$6.9 \times 2 =$	13.8
		$15.5 \times 12 =$	186
		$41.2 \times 26.8 =$	1104.16
		$30.5 \times 31.7 =$	966.85
		$28.2 \times 4 =$	112.8
Total Living Area (Rounded):	2384 Sq ft		
Non-living Area			
2 Car Attached	492.68 Sq ft	$22.6 \times 21.8 =$	492.68
Wood Deck	240 Sq ft	$15 \times 16 =$	240
Patio	239.04 Sq ft	$7.2 \times 33.2 =$	239.04

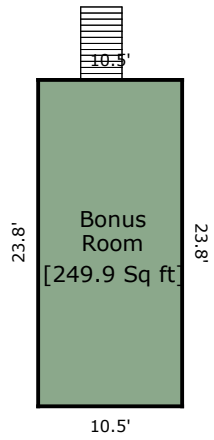

TOTAL Sketch by a la mode

Area Calculations Summary

Living Area	Calculation Details	
Second Floor	249.9 Sq ft	$10.5 \times 23.8 = 249.9$
Total Living Area (Rounded):	250 Sq ft	