

S A N D Y M U S H G A M E L A N D S

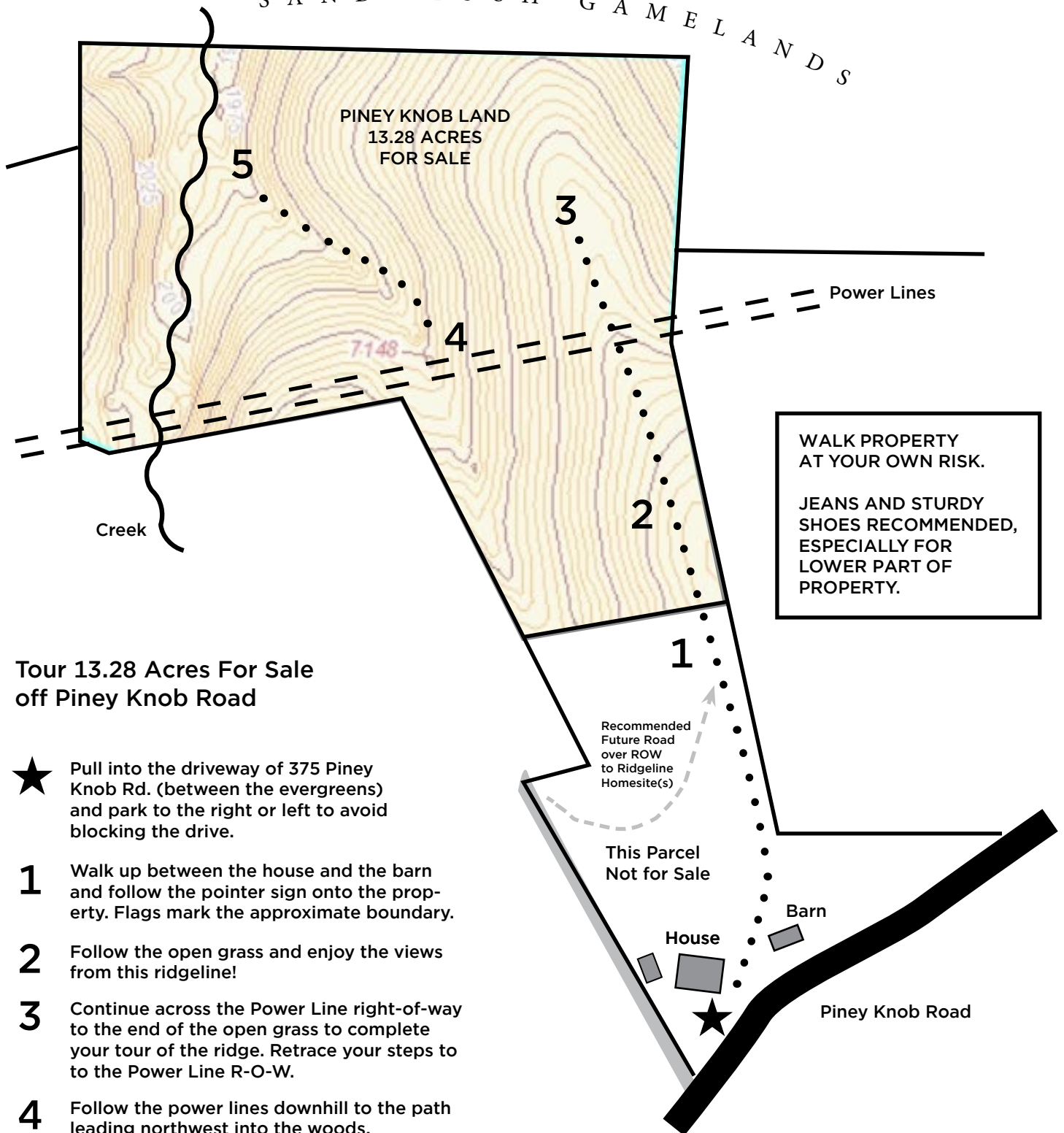

WALK PROPERTY AT YOUR OWN RISK.
JEANS AND STURDY SHOES RECOMMENDED, ESPECIALLY FOR LOWER PART OF PROPERTY.

Tour 13.28 Acres For Sale off Piney Knob Road

- ★ Pull into the driveway of 375 Piney Knob Rd. (between the evergreens) and park to the right or left to avoid blocking the drive.
- 1** Walk up between the house and the barn and follow the pointer sign onto the property. Flags mark the approximate boundary.
- 2** Follow the open grass and enjoy the views from this ridgeline!
- 3** Continue across the Power Line right-of-way to the end of the open grass to complete your tour of the ridge. Retrace your steps to the Power Line R-O-W.
- 4** Follow the power lines downhill to the path leading northwest into the woods.
- 5** Follow the path downhill to the creek. You are welcome to follow the creek in either direction to explore the property further. When done, return to your car via Points 2 and 1.

CALL LISTING AGENT MATT BARKER AT 828.242.6345 FOR PARKING AND ACCESS PERMISSION BEFORE WALKING THE LAND!
IF YOU ARE AN AGENT, PLEASE REGISTER YOUR SHOWING VIA SHOWING TIME OR BY PHONE CALL.